

PowerView® Gen 3 Gateway and Gateway Pro

The new PowerView® Gen 3 Gateway and Gateway Pro provide the best PowerView experience for the dealer, installer, and consumer. They can be easily added to any PowerView Gen 3 system, and **gateway setup takes place at the end of the PowerView Home setup**, NOT at the beginning. It takes just minutes to add to any project, and the homeowner's Wi-Fi password is NOT needed during initial setup!



Two gateway options

	PowerView Gen 3 Gateway	PowerView Gen 3 Gateway Pro
Number of shades	15	30
Wi-Fi Enabled (Both 2.4 and 5 GHz)	√	√
Ethernet Enabled		√
Power over Ethernet (PoE) Enabled		√

How it works

PowerView Gen 3 without a Gateway

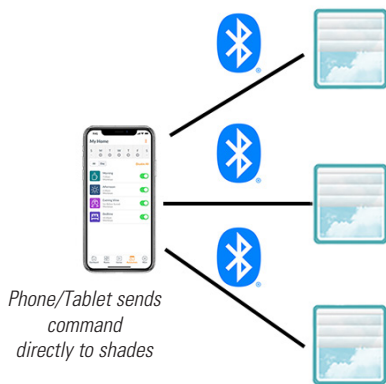

PowerView Gen 3 with a Gateway

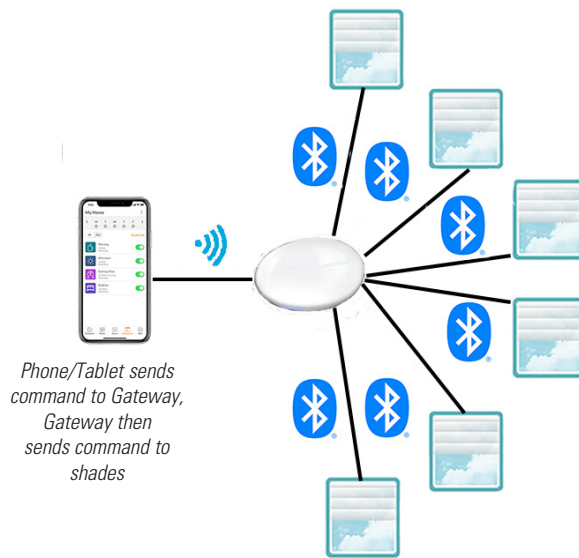

HunterDouglas 
hunterdouglas.com

How a gateway provides the most optimal PowerView® Gen 3 experience

3rd party integrations: Control your shades with your favorite voice assistant or home automation system. In addition to activating Scenes, PowerView® Gen 3 provides new features including natural language voice control. You can now open individual shades, move shades to exact positions, and have room awareness capabilities for the commands you say.

RemoteConnect™

- As a consumer, control your home while you're away like never before. With PowerView Gen 3, you not only can operate Scenes, but you can now control individual shades as well as create, edit, and delete Scenes and Automations.
- As a dealer or installer, you can be added as a User to any of your customer's homes and remotely access almost all of the PowerView Home's settings. You can troubleshoot a lot of questions remotely and drastically reduce house calls!

Range extender in large homes: Have shades that are spaced throughout a large home? A gateway provides additional range and reliability to ensure all shades operate when you want them to. Mix and match both gateways as needed for any project size.

Shades will always move in sync together

- For projects with more than four shades, a gateway will ensure shades move in sync with one another (hembar aligned) when receiving Scene commands from your phone.
- For projects with shades in more than one room, a gateway will ensure all shades receive their commands and move at the same time.

Shades' clocks stay in alignment with one another

- With PowerView Gen 3, each shade has an internal clock that allows it to run Automations. Like all clocks, they will become slightly misaligned over time. A gateway will update your shades' clocks every day to ensure Automations always trigger at the same time for each shade. Without a gateway, the homeowner will need to frequently open the PowerView App and keep the app running in the background. The PowerView App will update shades' clocks twice a day, but if your customer frequently hard-closes apps and does not plan on using the app often, add a gateway to the Home.

When should I add a gateway to a project?

We recommend adding PowerView Gen 3 Gateway or Gateway Pro to all but your smallest projects.

Here is quick summary of when a gateway is required or recommended for a PowerView Home:

Scenario: The homeowner wishes to use voice control or home automation systems to operate their PowerView shades.

Decision: **Required**

Scenario: The homeowner wants to control shades while physically away from the home through PowerView's RemoteConnect™ feature.

Decision: **Required**

Scenario: YOU as a dealer/installer want the ability to remotely access your customer's Home to troubleshoot when the homeowner calls with questions.

Decision: **Required**

Scenario: The consumer has more than four shades in the Home.

Decision: **Recommended**

Scenario: The consumer wants to enable Automations in the Home.

Decision: **Recommended**

Scenario: The consumer has a large home and wants the best range connectivity and reliability when sending shade commands.

Decision: **Recommended**

Scenario: The consumer has window coverings in more than one room.

Decision: **Recommended**

Scenario: The consumer has four or less window coverings in the same room and does not wish to utilize Automations, RemoteConnect, or 3rd party integrations.

Decision: **Not Recommended**

